

Andrea Moda S921

Monaco GP 1992

S921

1/20 scale Multimedia kit

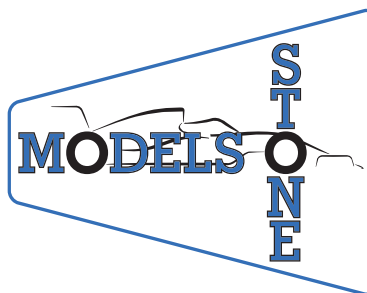

LIMITED EDITION



ASSEMBLY INSTRUCTIONS

IMPORTANT INFORMATIONS

- The kit is made by 3D print resins.
- Don't use Resin Wash.
- Thin resin parts are easy to deform. Carefully adjust with a hair dryer or hot water at 60°C or higher. Don't boil resin parts.
- Don't immerse in water, hot water, or solvents for a long time. Absorbs water and solvents.
- After washing with water, dry completely.
- Smooth the parts by sand papers and nippers.
- Various type of putty are available.
- Use epoxy or CA glue only.
- Please try temporarily assembly the kit before applying any adhesives.
- Recommend to apply primer surfacer before painting.
- Decals are not pre-cutted. They must be cut individually.
- Don't rub the decals too much, it's easy to scratch.
- If you use any decal softer or setter practice at a not needed decal piece.

CAUTION

- Read carefully and fully understand all instructions before assembly.
- Extra care should be taken when using tools avoid personal injury.
- When using paint and cement (not included) read and follow their instructions.
- Assemble the kit away from the reach of children.
- Keep all parts and vinyl bags away from children.
- Model car for collectors. Not suitable for under 18 years old.

A021/2022

 PARTS DETAIL

- Decal Sheet



- Etching Sheet

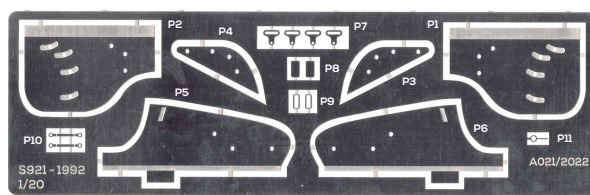

- Clear Resin and Rubber Parts / Screws / Rods

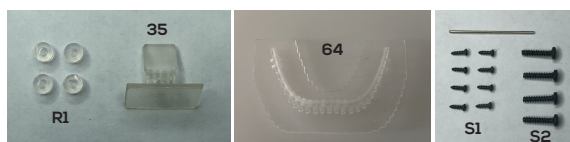

- Seat Belt Fabric

3 types of colored fabric (black, red and yellow)

- Resin Parts

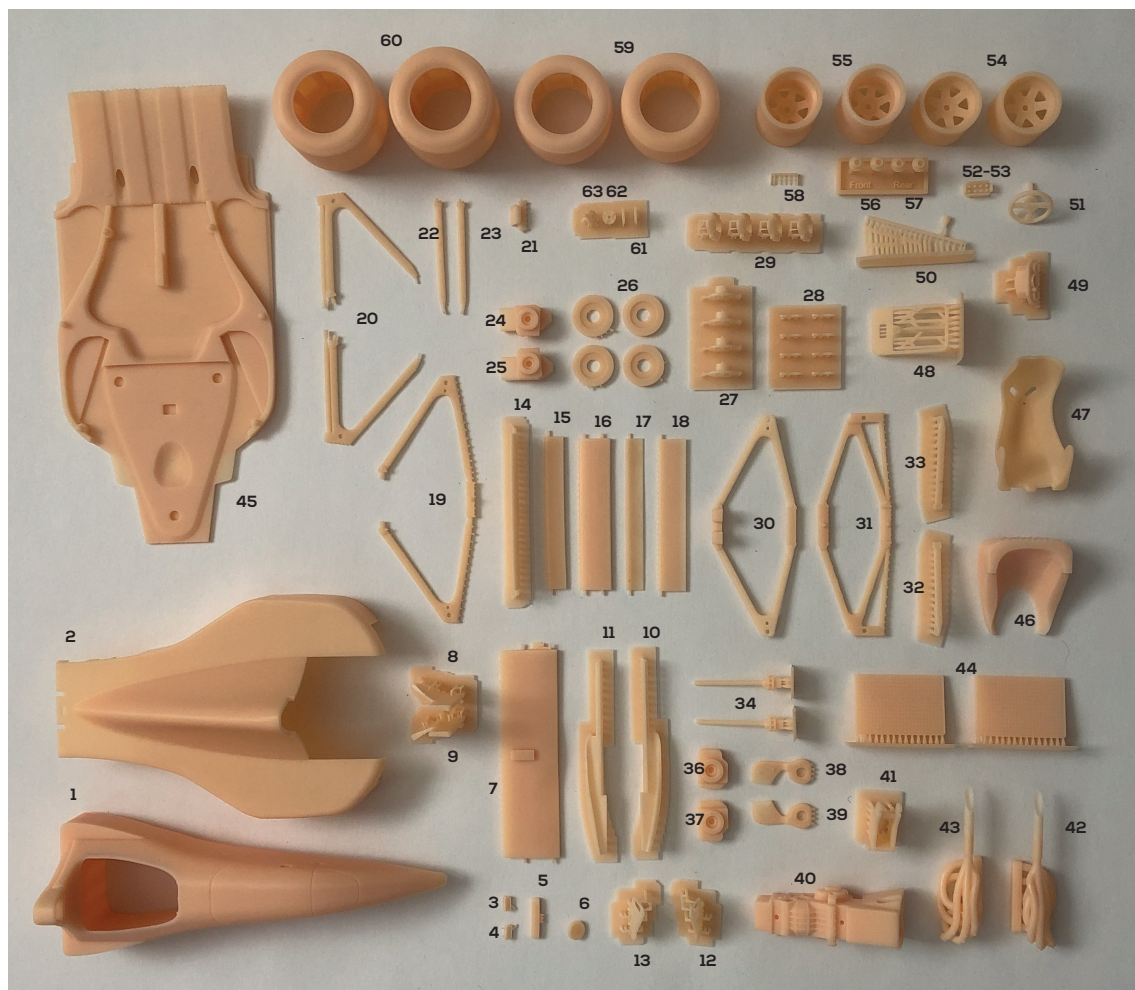

 PAINT GUIDE

[illegible]



DECAL GUIDE

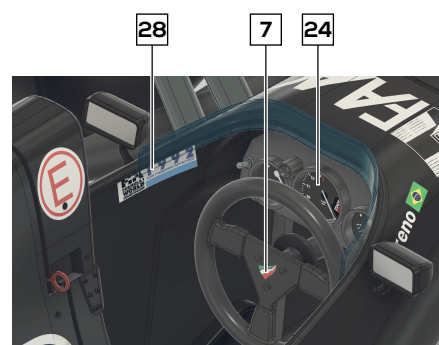
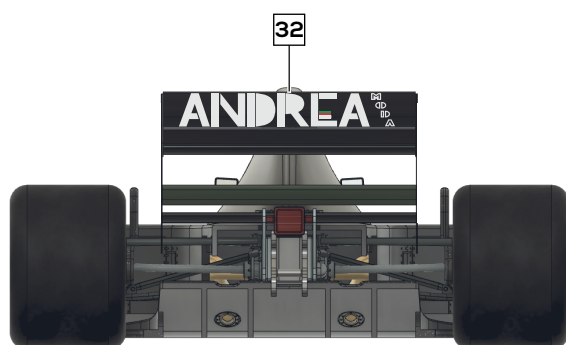
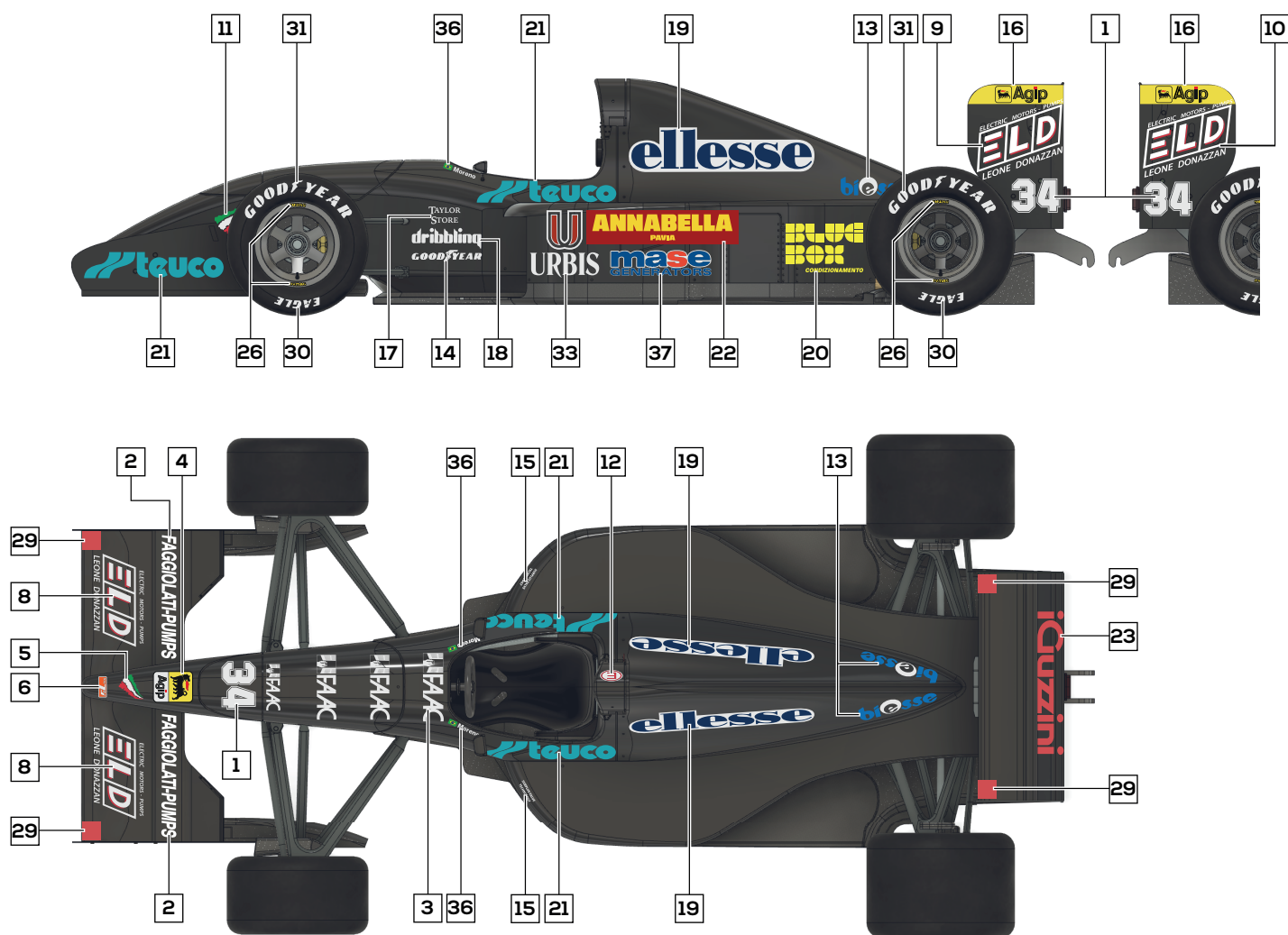

For **1** and **36** use optional decals to select the different drivers (34-Moreno / 35-McCarthy).

Use **25** or **27** for shoulder pads of seat belts.

Check for **36** regarding left and right side position.



The decals are made by digital technology.
Decals work the same way as other water slide decals.

The cover lacquer is on the entire surface of the sheet, so it's necessary to first cut each print off the sheet with a small overlap. Then immerse the decal in warm water and place it on a non-absorbent surface with the underlying paper down. Leave the printout off until it's easy to move on the underlying paper. Use a soft brush to place the decal on the desired location on the model. Clean the excess water with a clean cloth or paper towel and gently squeeze the print over the surface.

The decals react normally to products of the „Set“ and „Sol“ type. Even though, recommend to try them first.

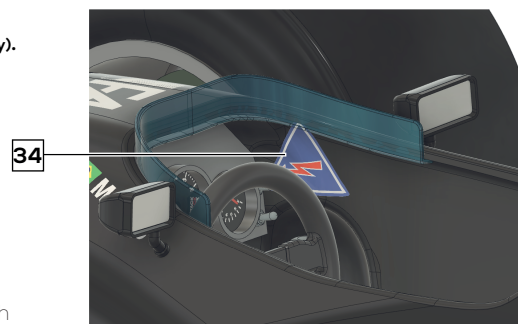

- 1** Remove the support structure if necessary and smooth all parts by sanding.



2 Rear Hub and Brakes Assembly

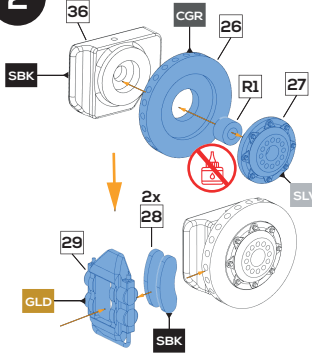

Assemble the pieces in the listed order, left to right, top to bottom. It is not necessary to glue R1.

Repeat the assembly for the right side in mirror image. Use parts #37/26/R1/29/28/29.

! Make sure to attach the brake line downwards.



3 Gearbox and Rear Suspension Assembly

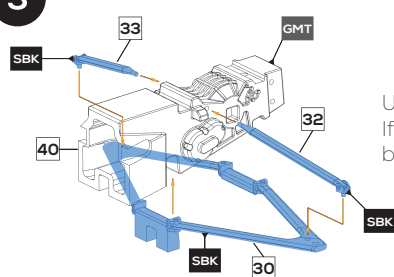

Use glue to connect the parts. If necessary, redrill the holes to be able to assemble the parts.

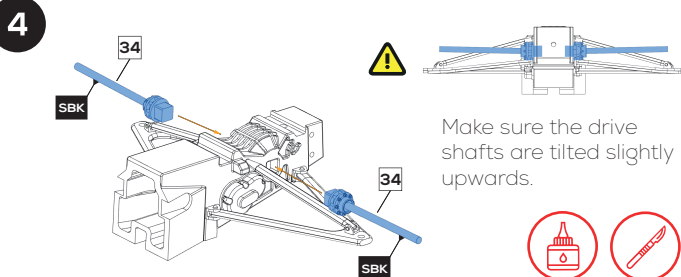

Make sure the drive shafts are tilted slightly upwards.

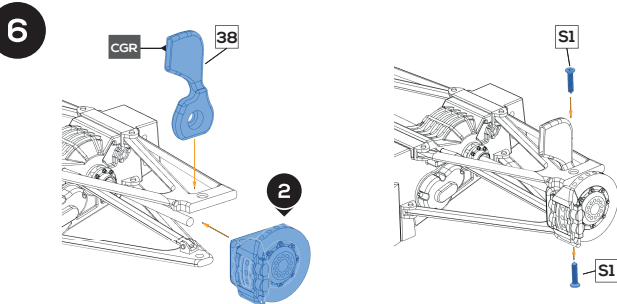
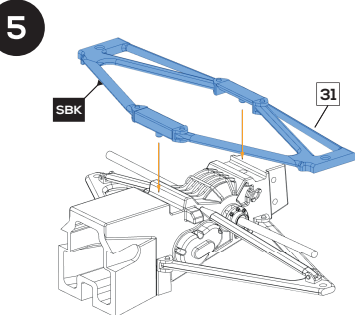

Repeat the assembly for the right side in mirror image. Use part #39.

A hole of $\varnothing 0.9\text{mm}$ is recommended for the screws. Therefore, drill out the holes in the hubs.

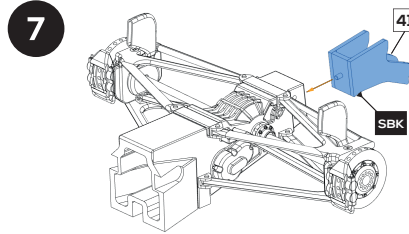

8 Rear Wing Assembly

The rear wing holders are pushed over the rear wing element and mounted on the gearbox.

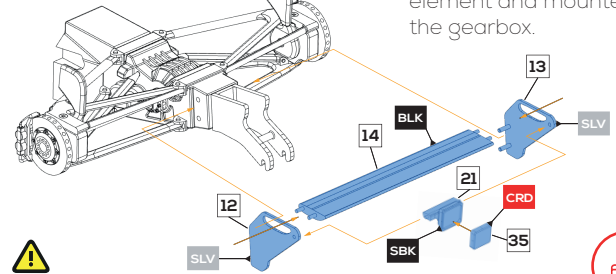

The rear light holder must be installed at the same time.

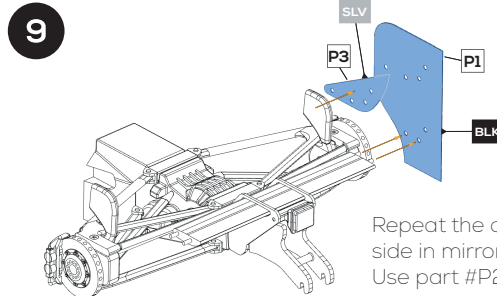

Repeat the assembly for the left side in mirror image. Use part #P2/P4.

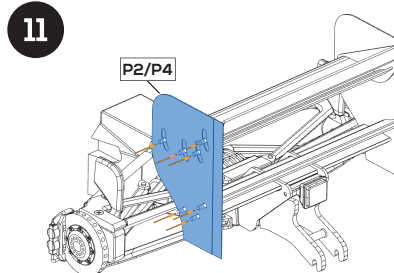
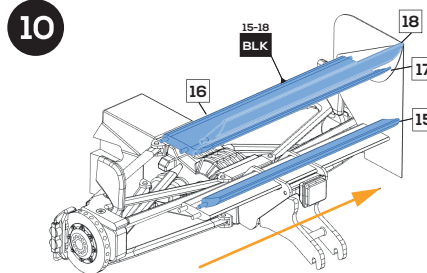

After assembly, the pins can be shortened.



12 Rear End and Floor Assembly

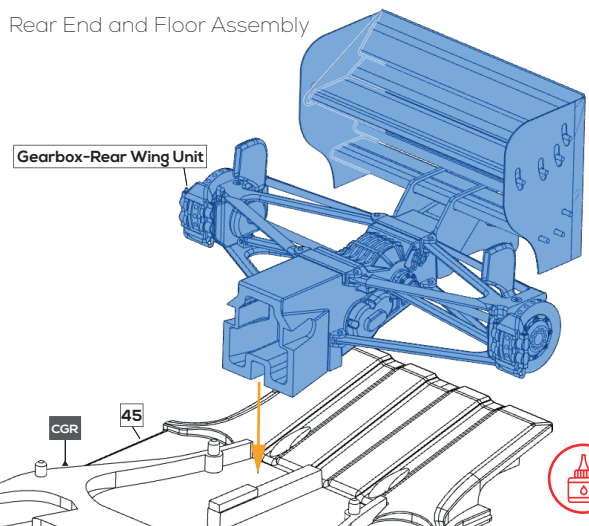

13 Exhaust Sytem

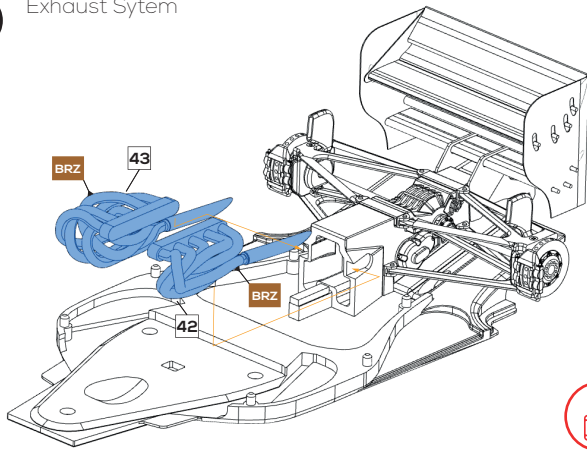

14 Radiators

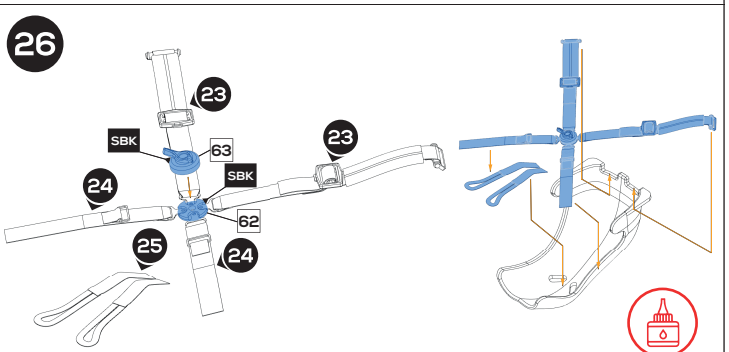
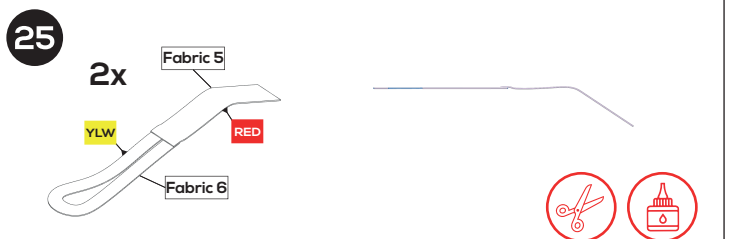
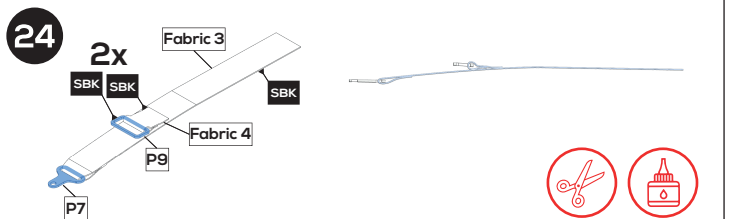
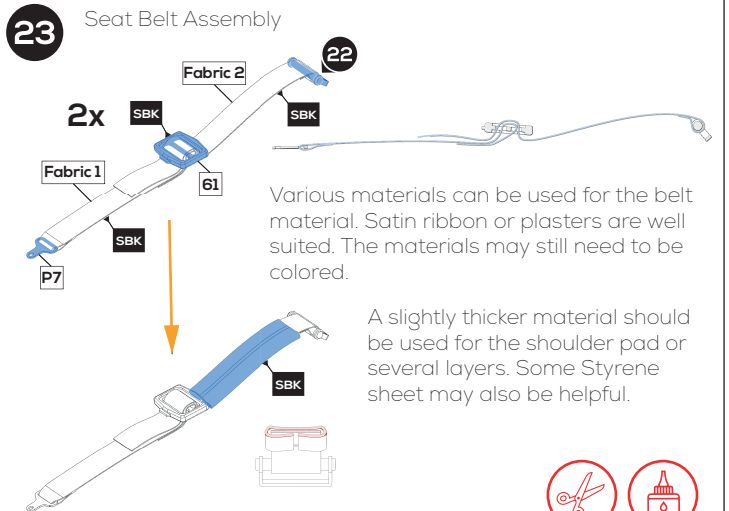
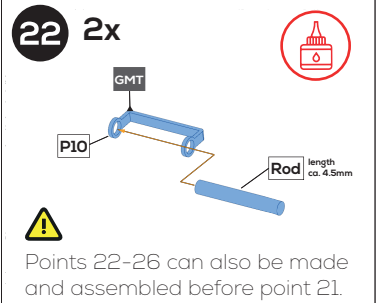
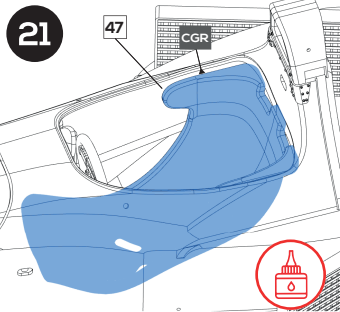
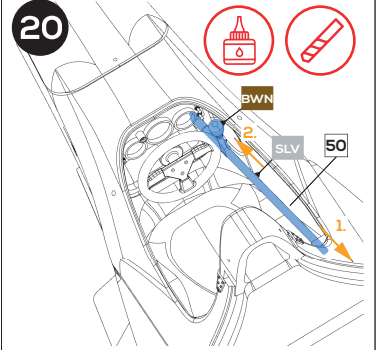
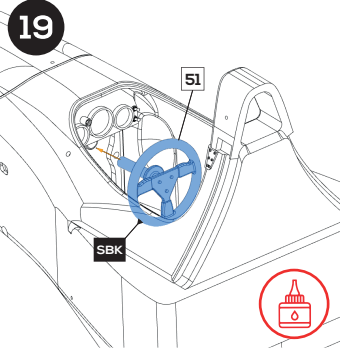
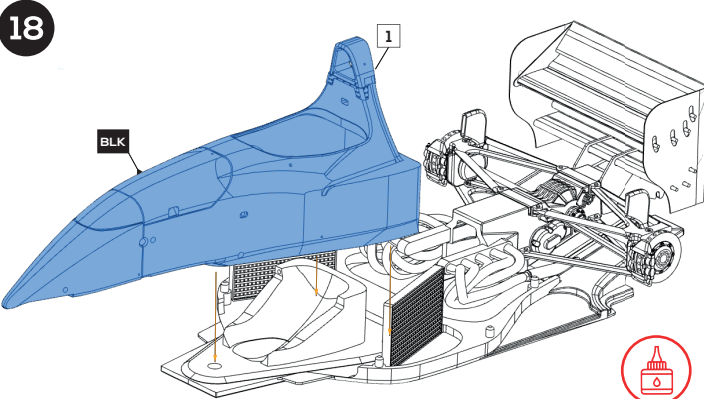
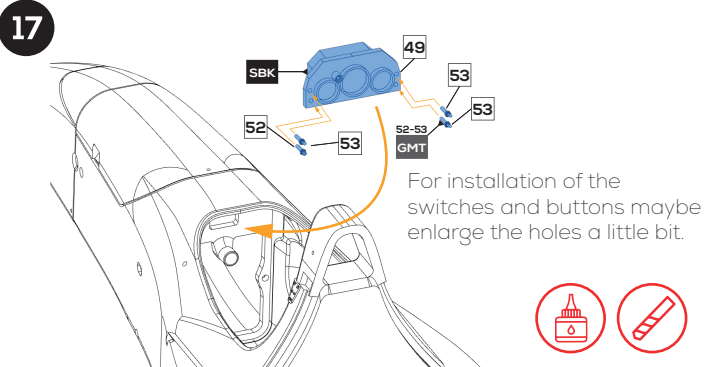
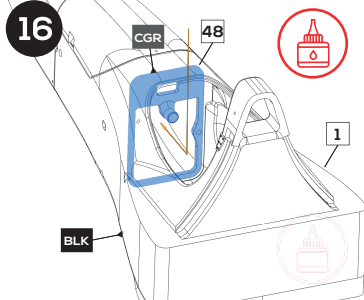
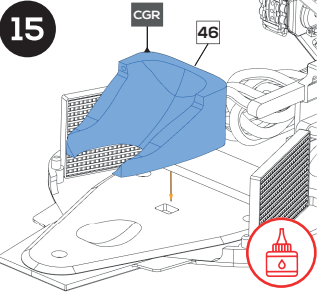
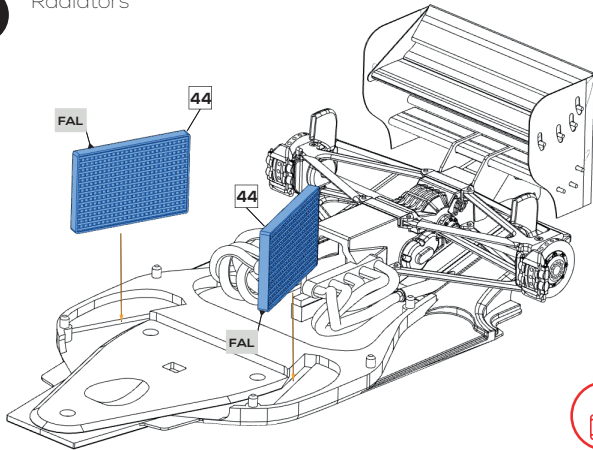

27

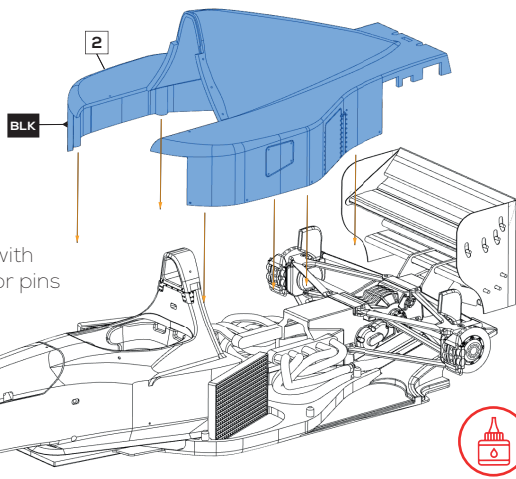

Install the Engine Cover with the 3 connector pins on each side.



28

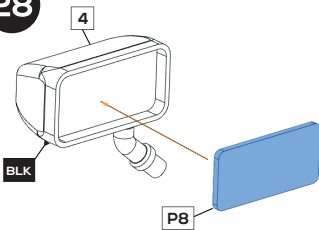

Repeat the assembly for the right side in mirror image. Use part #3 and P8.

It is recommended to use fine sandpaper and polishing paste to polish the mirror surfaces.



29

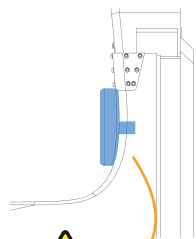
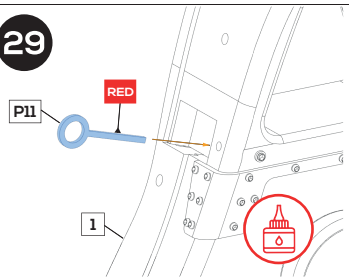

30

Make sure to install the headrest in right direction.

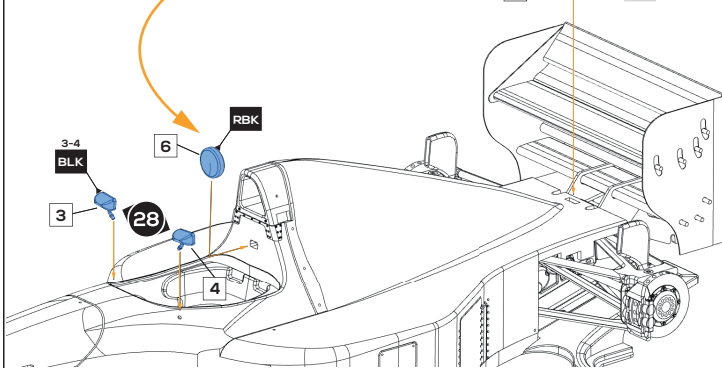

31

Front Hub and Brakes Assembly

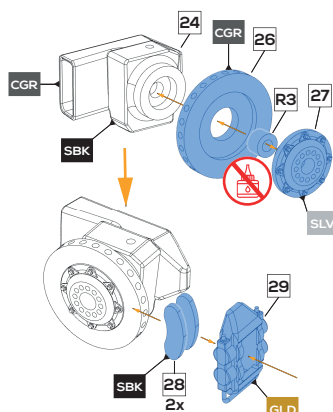

Assemble the pieces in the listed order, left to right, top to bottom. It is not necessary to glue R1.

Repeat the assembly for the right side in mirror image. Use parts #25/26/R1/27/28/29.



Make sure to attach the brake line downwards.



32

Front Suspension Assembly

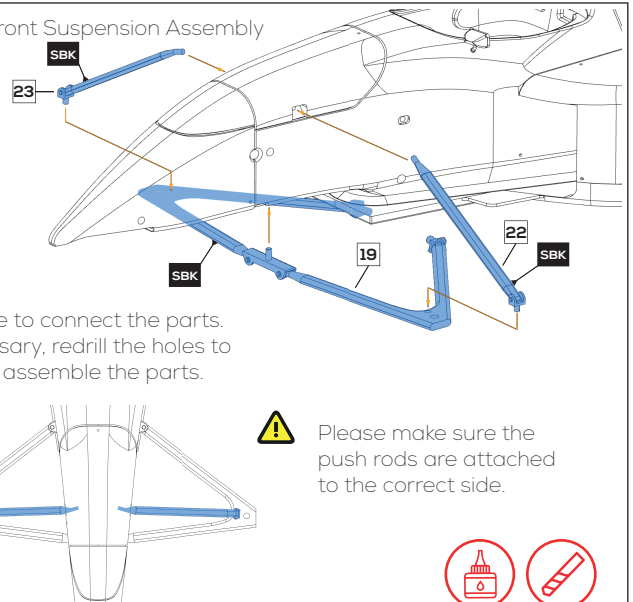

Use glue to connect the parts. If necessary, redrill the holes to be able to assemble the parts.



Please make sure the push rods are attached to the correct side.



33

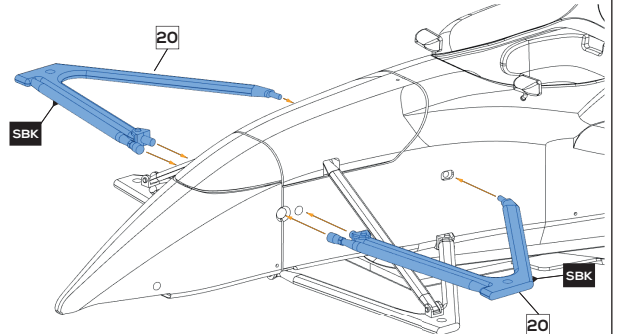

Use glue to connect the parts. If necessary, redrill the holes to be able to assemble the parts.



34

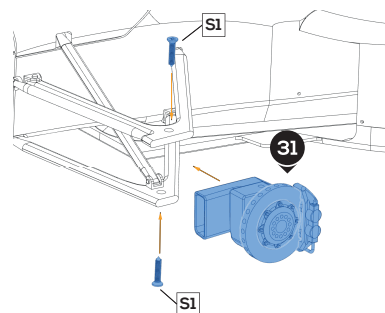

Repeat the assembly for the right side in mirror image.

A hole of Ø0.9mm is recommended for the screws. Therefore, drill out the holes in the hubs.



35

Front Wing Assembly

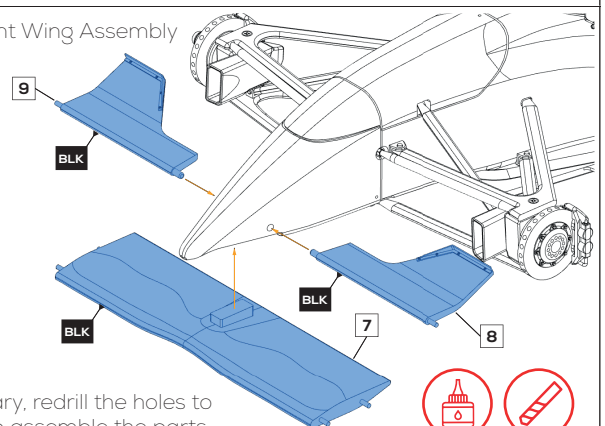

If necessary, redrill the holes to be able to assemble the parts.



36

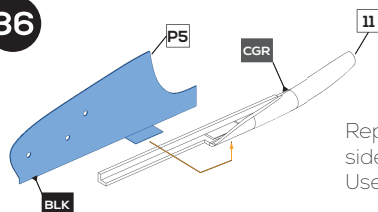

Repeat the assembly for the left side in mirror image. Use part #P6/10.

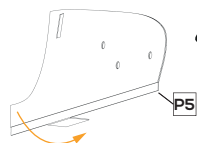

Make sure to bend the flap on the PE part in the right direction.



37

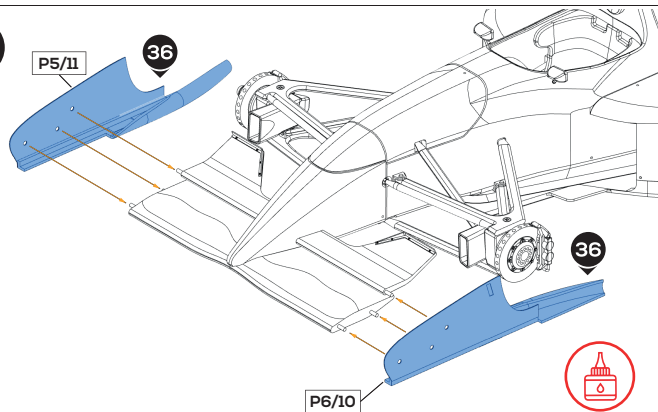

38

4x

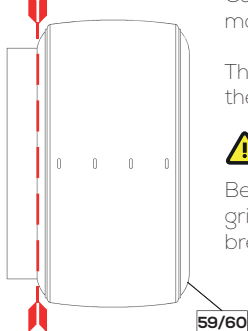

Cut or saw off the support ring in the marked area.

Then sand down the sidewall until the ring is no longer visible.



Be careful when cutting/sawing or grinding so that the ring doesn't break off.

Also pay attention to the detailing lines and try not to erase them when sanding.

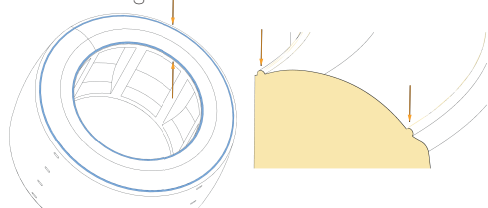

39

Wheel and Tire Assembly

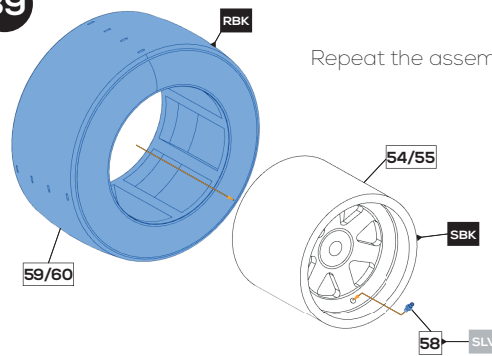

Repeat the assembly for all 4 pairs.



40

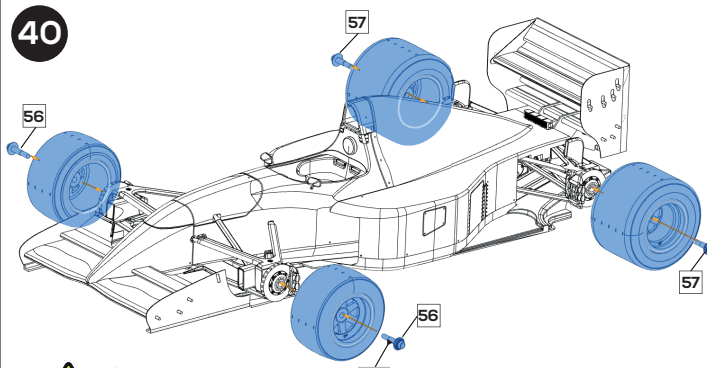

2 options

You can also use screw S2 to assemble the wheels.

4x



41

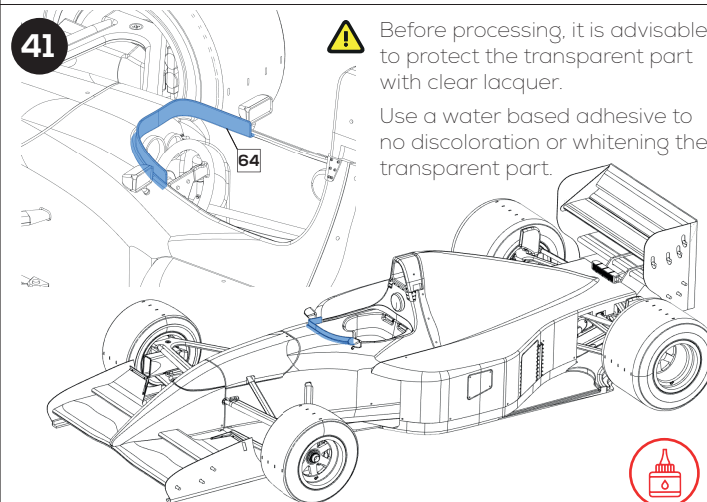

Before processing, it is advisable to protect the transparent part with clear lacquer.

Use a water based adhesive to no discoloration or whitening the transparent part.



Note:

This instruction is also available as a PDF file under the following link:

<https://stone-models.com/download>



Explanation of symbols:



Use a file or sandpaper

Drill

Glue

Use a knife or scalpel

Don't use a knife or side cutter

Use a scissors

Use a side cutter

Screw

Special Thanks to

Sauro Torreggiani for letting me use his illustrations.

Support him on <https://www.patreon.com/saurotorreggiani>

Luboř Vinař for help me with decal production.

Support him on <https://www.vinar.cz>

Markus Wendt and Jan Merhaut for help with this project.

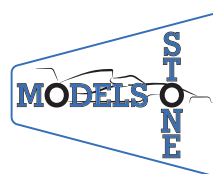

COPYRIGHT © 2023
by STONE Models



Thank You!

FOR YOUR PURCHASE

Thank you for your order and support me!
Don't forget to share your experience.